HQUA

Instruction Manual for The Housing/Cabinet of the PAS Pond Aeration System HQUA-ASC01

Section 1 Safety Information

Before starting the installation job, it's very important to read the entire instructions below. Make sure that you understand these in order to avoid potential hazards. Failure to do so may result in serious personal injury or damage to the equipment.

Electric Shock

- To reduce the risk of electric shock, connect only to a properly grounded, grounding-type receptacle. If in doubt, have the outlet checked by a qualified electrician.
- Always a circuit protected by a ground fault circuit interrupter (GFCI).
- Disconnect unit from power source before handling or maintaining

Safety Precautions

- Locate the cabinet on a solid surface with adequate strength that could hold the unit.
- Locate the cabinet above the high-water line and away from the irrigation sprinklers.
- Flooding and heavy rains should be considered.

Section 2 General Information

2.1 System Components

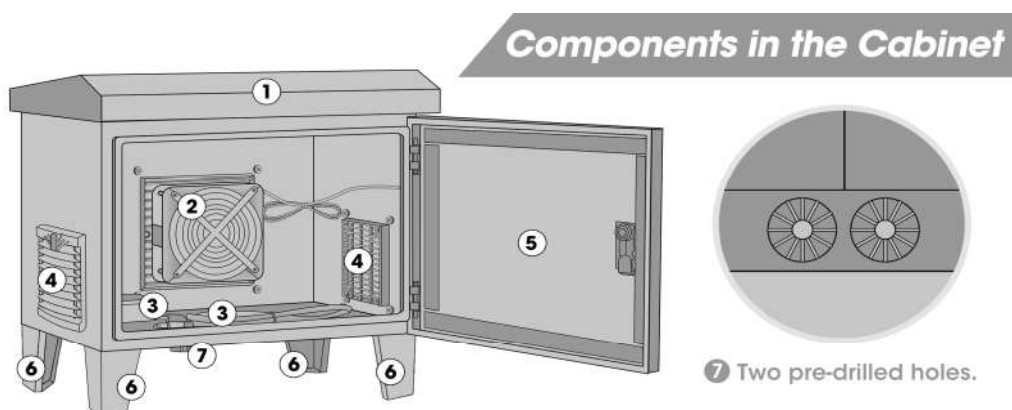

① Weatherproof galvanized steel housing.

② High flow cooling fan.

③ Pre-wired electrical box and 10' 3-pin plug cord.

④ Double air filters.

⑤ Waterproof cabinet door.

⑥ Removable footholds.

⑦ Two pre-drilled holes.

Size: 19"W * 14"D * 18.5"H 28LB

2.2 Location

Find a stable ground to settle the cabinet. The bottom side is not weatherproof. Flooding and sprinkler should be considered. Always remain the cabinet above the high water line.

Pond's edge

If a power source is available near the pond's edge, locate the cabinet at the pond's edge for quicker installation.

Away from Pond's edge

If a power source is not available near the pond's edge or you prefer a better place. You could install it next to the barn/shed/house.

Notice:

- The airline would increase the pressure to the pump. For PAS10 system, it would increase 0.35-0.4 bar (5-5.8 PSI) for each 100' air hose. That means the MAX depth would diminish 11-13 ft. For PAS20 system, it would increase 0.17-0.2 Bar (2.5-3 PSI) for each 100' air hose (no matter which air way). The MAX depth would diminish 5.5-6.5 ft.

2.3 Installation

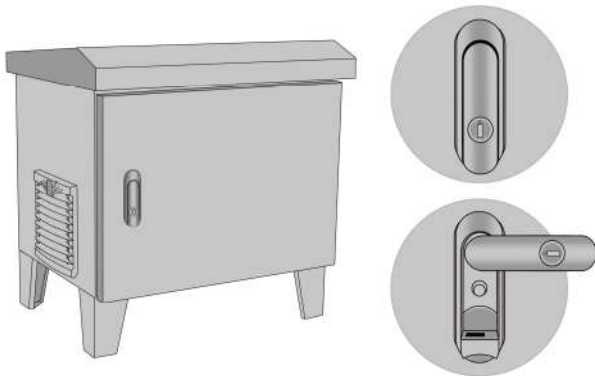

1. Unlock and open the cabinet door (We have a key to lock the cabinet if you worry about the safety). Through the power cords out from the bottom holes.

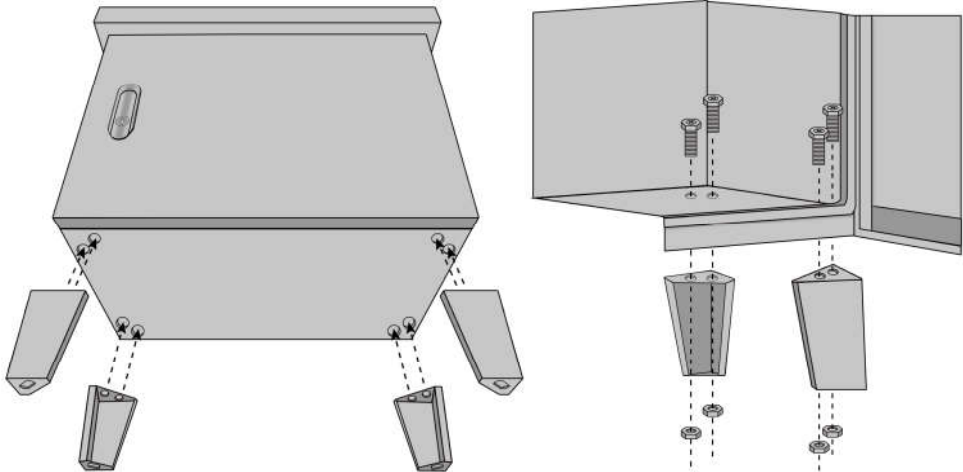

2. Place the backside of the cabinet on the ground and screw the 4 footholds on.

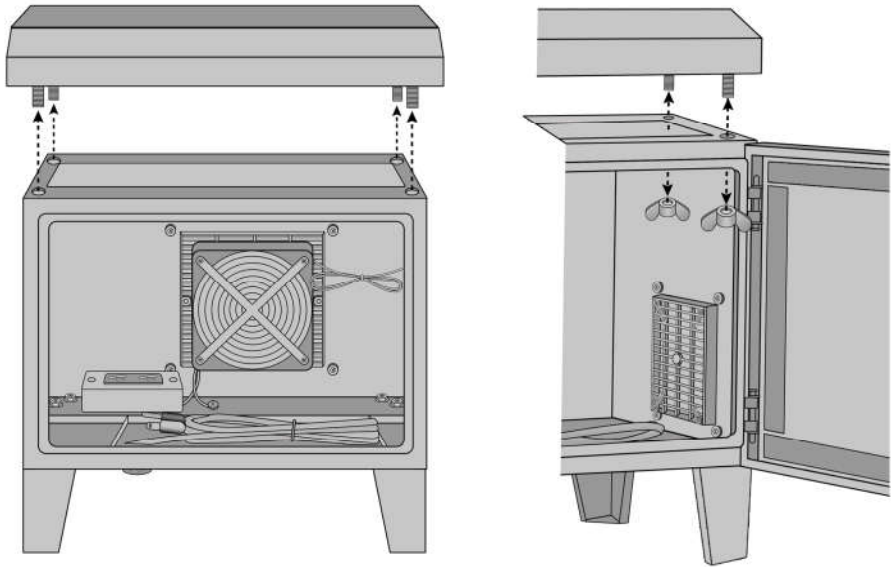

3. Screw off the roof from the corners. No need tools.

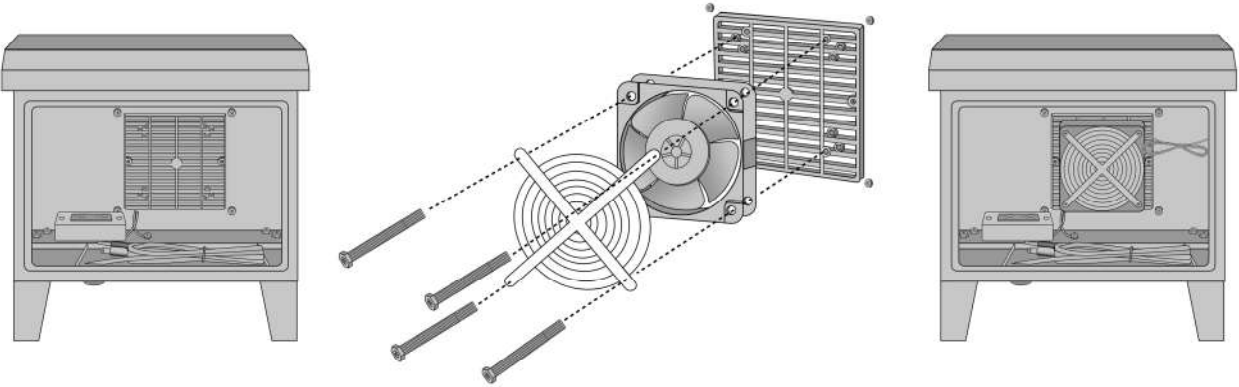

4. Fit the grill protector and the fan with 4 screws and fix them on the cabinet inner grill. The hump side should be towards outside, if not done so, it would stick the fan and buzzing when the power is on.

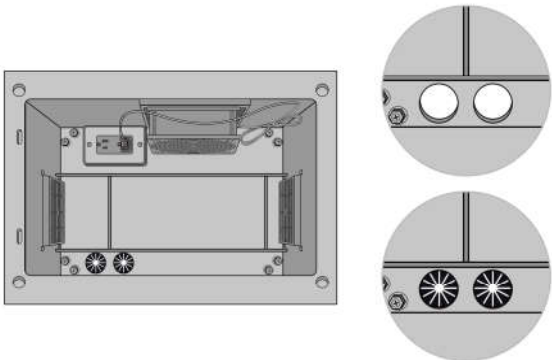

5. Install the hole covers at the bottom for the airlines.

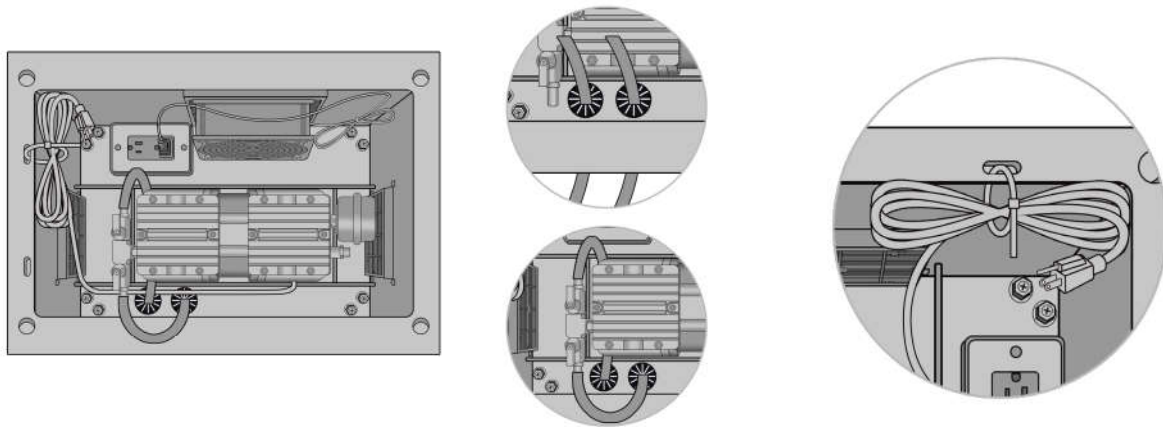

6. Place your pump into the cabinet from the top side.

Notice: Direction is important for the ventilation. The air outlet should be at the same side of the power outlet. The air filter should towards to the opposite.

Fix the spare pump power electric cords on the cabinet to avoid running around and get damaged.

7. Insert the airlines through the hole covers and connect the pump with the hose clamps.

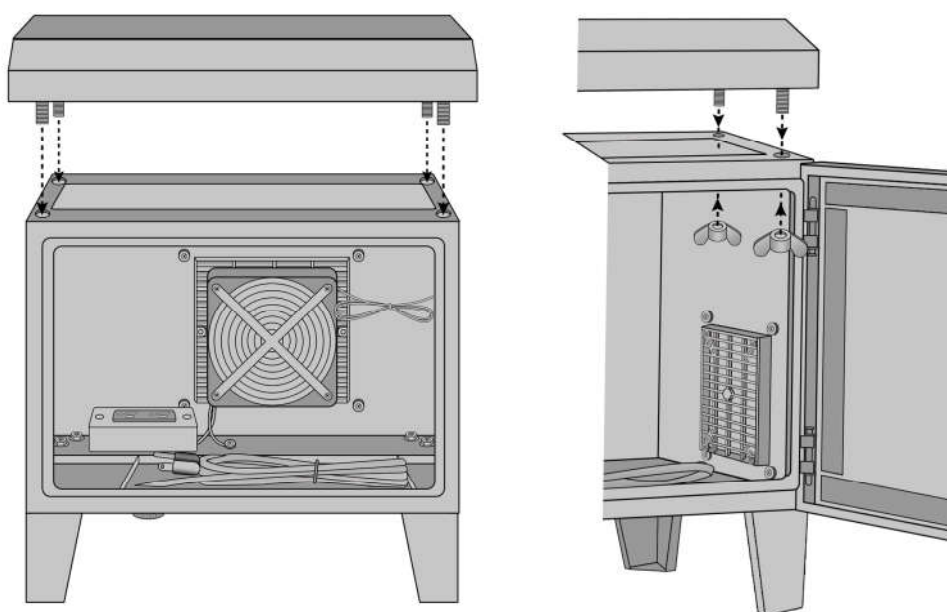

8. Screw back the roof on the cabinet.

The outlet in the cabinet is pre-wired to the power plug and grounded. Connect the power plug with the outdoor outlet or hard-wire with a waterproof junction box/connector/glue. Should be protected by GFCI.

Section 3 Maintenance

It is suggested to clean the sponge filter monthly. Wash and dry are needed if it is clogged severely. Normally, it would need to be replaced annually. But if it is uncleanable, you should replace it.

Section 4 Specification

Voltage	Ventilation	Revolving Speed	Wattage	Size	Weight
110-220V	196 CFM	3000 RPM	21W	19"W*14"D*18.5"H	28 Lb

This Cabinet fit for HQUA PAS10/PAS20 Aeration system. If you use some other pump, we cannot guarantee it would fit the size and the operation.

Section 5 After-Sales Service

If you need any support, or have questions about the system, please contact our Technical Support team via hqua.tech@gmail.com and we will be glad to assist you. We sincerely hope that you enjoy the benefits of clean

Our Commitment

Two-Years Limited Warranty for Electrical parts

HQUA warrants that the fan and the electric cords/outlets are free from defects of material and workmanship for a period of 2 years from the date of purchase. During this period, HQUA will repair or replace, at its option. Please return the defective part to your dealer for claim.

Five-Years Limited Warranty for Cabinet.

HQUA Warrants the cabinet would stay in a good condition in 5 years. Rust and human/environment damage are not included. During this period, HQUA will repair or replace, at its option. Please return the defective part to your dealer for claim.

Part Number List

Part Number	Description
ASC01C	Main structure of the cabinet
ASC01R	Roof of the cabinet
ASC01E	Combination of the power outlet and the electric cords
ASC01F	6" 196 CFM 3000 RPM 110V 60Hz Ventilation Fan
ASC01H	Footholds
Accessories	
ASC1001	5/16"-18 × 1/2" Phillips Hex Washer Head Machine Screw
ASC1002	5/16"-18 Flange Hex Nut
ASC1003	1/4"-20 Butterfly Nut
ASC1004	8-32 × 2.5" Phillips Pan Head Machine Screws
ASC1005	1-1/2" Hole Cover
ASC1006	5" Nylon Cable Tie
ASC1011	6" Stainless Steel Fan Grill Cover
ASC1012	5" Foam Pre-Filter
ASC2001	6" Louvered Air Vent Grill Cover
ASC2002	8" Louvered Air Vent Grill Cover

.....The End.....